



IT'S ALSO A FAMILY STATION WAGON.



SWIVELLING FRONT PASSENGER'S SEAT.



STOVE (MODEL P-27). KITCHEN SINK.



SLEEPS FIVE WITH THE OPTIONAL POP-UP TOP.



**Interior features of the Standard Campmobile (P-21) and Pop-up Top Campmobile (P-22):**

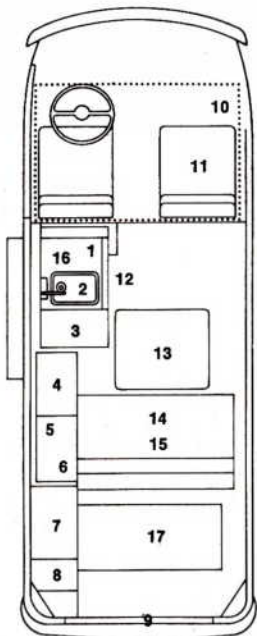

1. Spare tire
2. Stainless steel sink with electric water pump
3. 7½ gallon water tank
4. Icebox
5. Fluorescent ceiling lamp
6. Storage bin
7. Clothes closet
8. 3 storage areas
9. Rear lid screen
10. Child's hammock
11. Swivel seat
12. Utensil cabinet
13. Dining table
14. Storage locker below bench
15. Upholstered bench—converts to double bed
16. Louvered windows
17. Ceiling cabinet

**Additional features of the Deluxe Campmobile (P-27):**  
 Upholstered storage container  
 2-burner stove  
 12-volt refrigerator (replaces icebox)  
 Snack table

**1977 CAMPMOBILE SPECIFICATIONS**

<b>ENGINE:</b>	Type	Air-cooled, rear mounted
	Cylinders	4 cylinders, opposed
	Displacement	120.2 cubic inches (1970 cc)
	SAE Net HP	67 @ 4200 rpm
	Fuel/Air Supply	AFC fuel injection
<b>TRANSMISSION &amp; DIFFERENTIAL:</b>	Type	Fully synchronized, transaxle
	No. Speeds	4 forward, 1 reverse
	Final Drive	Rear wheel drive, double-jointed axles
	Clutch	Single disc, dry
<b>CHASSIS &amp; SUSPENSION:</b>	Frame	Unitized body/chassis, box-shaped side and cross members
	Front suspension	Independent, torsion bars with trailing arms and stabilizer
	Rear suspension	Independent, torsion bars with trailing and diagonal arms
	Service Brake	Dual brake circuit, power-assisted discs/drums. Inertia controlled pressure regulator, rear
	Parking Brake	Cable operated on rear wheels
	Rim Size	5½J x 14
	Tire Size	185 R 14
	Steering	Roller type
<b>ELECTRICAL SYSTEM:</b>	Rated Voltage	12 Volt, 55 Amp alternator
	Battery	12 Volt, 54 Amp/hour
<b>DIMENSIONS:</b>	Wheelbase	94.5 inches
	Length	177.4 inches
	Width	67.7 inches
	Height (Unloaded)	77.0 inches (81.0—P22, P27)
	Ground Clearance (Loaded)	7.9 inches
	Turning Circle	37.1 feet (curb to curb)
<b>PERFORMANCE:</b>	Top Speed	75 mph
	Fuel Consumption*	Highway: 26 mpg
		City: 16 mpg

\*Based on 1976 EPA estimated mileage with manual transmission. Your actual mileage may vary, depending on where and how you drive, your car's condition and optional equipment. 1977 data not available at press time. Ask your local dealer for a free copy of the EPA/FEA Gas Mileage Guide for New Car Buyers.

# VW Campmobile.

## For people who believe a family's car should be it's castle.

Maybe we shouldn't even call it the Campmobile. After all, more times than not, people use it as a passenger car. Or for hauling things that are far too big to fit into ordinary family cars.

And when you're away from home, camping in our Campmobile is really much too comfortable to call it camping. All the luxuries are there—even the kitchen sink and a spot for plugging in your TV.

As for driving, there's a powerful 2-liter fuel injected engine, roller-type steering, power-assisted disc/drum brakes, and even an electric rear window defogger.

While our Campmobile is a parkable and maneuverable 177.4" long, it can sleep five with the optional pop-up top—even when four of the five are adults.

One more thing. Besides saving on motel bills, our Campmobile also saves on gas bills. E.P.A. estimates\* indicate it gets 26 mpg highway, 16 mpg city.

Good gas mileage for a family's car. Spectacular for a family's castle.

\*Based on 1976 EPA estimated mileage with manual transmission. Your actual mileage may vary, depending on where and how you drive, your car's condition and optional equipment. 1977 data not available at press time. Ask your local dealer for a free copy of the EPA/FEA Gas Mileage Guide for New Car Buyers.



AUTHORIZED  
DEALER

