

MOTEL VOLKSWAGEN.

Next time you're thinking about getting away from it all, think about our 20 mpg, 65 mph motels. They're part of a chain of holiday resorts springing up all over Australia. There are four different models – all with all the usual up-to-date facilities.

MOTEL 

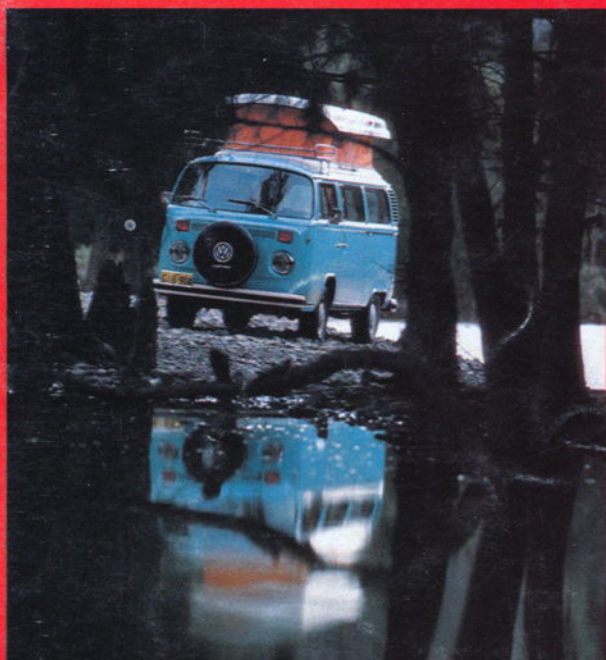

Inside:
Cruiser
Adventurer
Wanderer
Dormobile



CRUISER.



The Cruiser is our more conventional motel, particularly suitable for long-range touring. Cruiser gives you a wonderfully compact kitchen including a refrigerator and a self-contained cooker. The refrigerator can be powered off either 240 volts or the twin 12 volt batteries. You have a sliding door remote control—easy in—easy out. The timber finish is luxurious. Cruiser will seat five adults and sleep two in a six foot long double bed. Pull out another bed in the extendable roof and you've sleeping for two more adults or three children.

Cruiser by Day.

(1) Split front seats. (2) Sink with water storage under tap and

pump. (3) 2 burner stove. (4) Built-in fridge. (5) Fold-away table. (6) Mirror. (7) Rear seat with storage underneath. (8) Storage shelves. (9) Rear facing seat with storage underneath. (10) Storage cupboard in roof over seat. (11) Fluorescent light. (12) Hanging space. (13) Sliding drawer and work bench.

By Night.

(1) Dining table and rear seat fold down to form double bed. Roof extends to allow sleeping for two more.

Cruiser by Day.

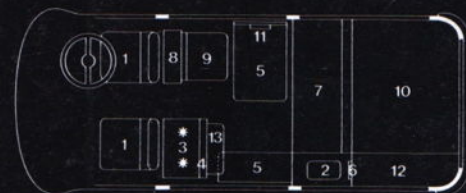

By Night.



ADVENTURER.



The thing that makes Motel Volkswagen different is that it lets you leave the place you're in, in the lodgings you're in.

Adventurer also comes with an elevator roof design to allow 7' of headroom within the vehicle when stopped. This extendable roof is made from sturdy, durable fibreglass with a fully waterproof shroud featuring screened ventilation openings. When in position, the extension provides a retractable bed for two adults or children.

Spare wheel relocated for extra storage room. Head restraint behind front seats. New sink/fridge/stove unit with slide-away work bench.

Sliding door remote control.

Adventurer by Day.

(1) Split front seats. (2) Sink with water storage under tap and pump. (3) 2 burner stove. (4) Built-in fridge. (5) Fold-away table (6) Mirror. (7) Rear seat with storage underneath. (8) Twin storage lockers. (9) Portable seat. (10) Relocated spare wheel. (11) Fluorescent light. (12) Roof storage. (13) Sliding drawer and work bench. (14) Hanging space.

By Night.

(1) Rear seat and table fold down to form a double bed. Roof extends to allow sleeping accommodation for two more.

Adventurer by Day.

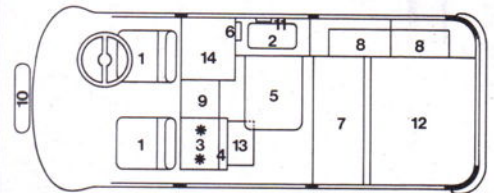

By Night.

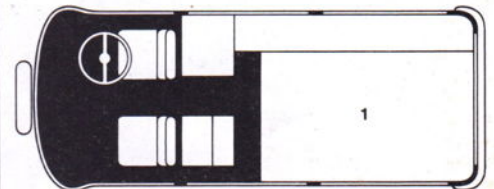

WANDERER.



Wanderer features a fixed fibreglass roof, giving 6' of standing room. Louvred windows in the roof open for fresh air, and are screened against bugs.

The easily convertible seat converts into a full length double bed by night.

All the comforts of home come as standard equipment including loads of storage and hanging space. You have a beautifully equipped kitchen with fridge, gas stove and stainless steel sink.

Wanderer by Day.

- (1) Split front seats. (2) Sink with water storage under tap and pump. (3) 2 burner stove. (4) Built-in fridge. (5) Fold-out

- table. (6) Overhead storage. (7) Rear seat with storage underneath. (8) Hanging space. (9) Portable seat. (10) Relocated spare wheel. (11) Fluorescent light. (12) Extra light. (13) Shelf storage. (14) Sliding drawer and work bench.

Wanderer by Night.

- (1) Dining table and rear seat fold down to form double bed.

Wanderer by Day.

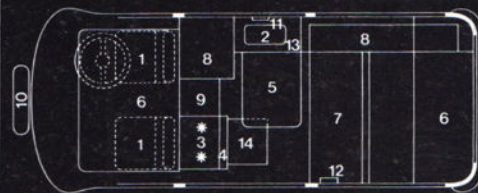

By Night.

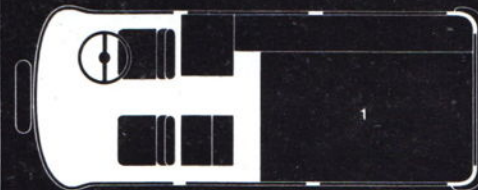

DORMOBILE.



Dormobile features a "bellows" extendable roof line with two swing-down adult-size bunks. Add this to the double size bed and you have sleeping accommodation for four.

And like all our motels, Dormobile comes complete with colour matched durable floor coverings. It is fully lined, and trimmed. A gas cooker/grillier lifts out for self-contained outside use.

You have quality curtains on all windows. Extruded aluminium track and silent runners and gatherers.

Deep foam cushions, covered with quality vinyl covers. You have a stowable indoors/outdoors dining table. A sink with draining board, pump and water storage.



12 volt interior lighting. Clothes hanging space. Food, crockery, utensil and bedding storage lockers, a cutlery drawer and fire extinguisher.

Dormobile By Day.

(1) Split front seats. (2) Sink with water storage under tap and pump. (3) Fold-out 2 burner stove with grillier. (4) Built-in fridge. (5) Fold-away table. (6) Mirror. (7) Rear seat with storage underneath. (8) Built-in storage. (9) Storage lockers. (10) Relocated spare wheel. (11) Fluorescent light. (12) Shelf storage. (13) Hanging space. (14) Seat with storage under.



By Night.

(1) Table supports the rear seat which folds down to form double bed. (2) Roof folds out. Bunks in roof sleep 2 more.

Dormobile By Day.

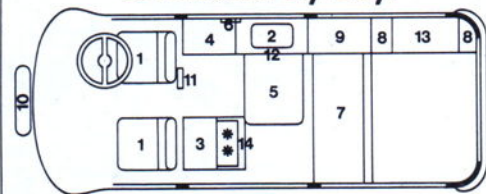

By Night.

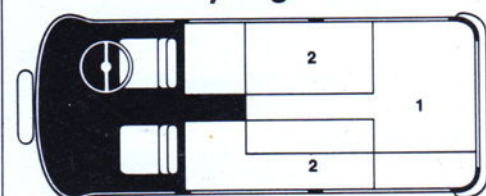

OPTIONS & ACCESSORIES.



Options. These additions to your home-away-from-home are factory made and should be ordered at the time you order your motel Volkswagen.

- Tent—10' x 10'
- Luggage rack
- Spare wheel relocation
- 240 volt power point
- Twin battery circuit
- Cabin bunk
- Tow bar
- Mosquito net set
- Retractable step
- Screened/sliding window
- Extra 2½ lb. gas cylinder
- Detachable windscreen protector
- Cupboard fittings and door (in lieu of fridge)
- Folding table and stools (2) set

- Picnic stools (set of 2)
- Picnic chairs (set of 2)
- Kangaroo bars with spare wheel relocation

- Gas power pack/ventilation

Accessories. Ask your dealer to fit any of these VW made accessories.

- Air horns
- Car care accessories
- Cigarette lighter
- Chrome grille cover
- Engine lid lock
- Fluorescent light
- Fog and driving lamps
- Gear knob
- Headlight guards
- Locking petrol cap
- Mudflaps
- Radio

- Seat covers
- Spare wheel carrier
- Spare wheel cover
- Steering wheel glove
- Sunvisor
- Touch-up paint
- Weathershield
- Wheel covers and dress rims
- Workshop manual

YOUR MOTEL ON THE MOVE.

Our motel has something you won't find in any other motel—a great big new 1800cc engine tucked away in the rear. It's very dependable and economical and it can't boil or freeze.

And because the engine's in the rear, the back wheels get exceptional traction, no matter how tough the going gets off the beaten track.

Our 65 mph motels will get

around 20,000 holiday miles before you'll have to change tyres. A double joint rear axle with independent torsion bar suspension smooths the ride even if you're headed for the Volkswagen Desert Inn. Our 1800cc motel comes complete with Uniroyal "Steel Cat" radials as standard equipment.

To keep you cool when it's hot and warm when it's cold, we

give you a beautiful fresh air/heating system.

And to give you more peace of mind in between stops, we give you power disc brakes up front, extra large rear drum brakes and a dual circuit no-fail braking system to stop you.

So our motel isn't just a nice place to live, it's also a nice place to drive.

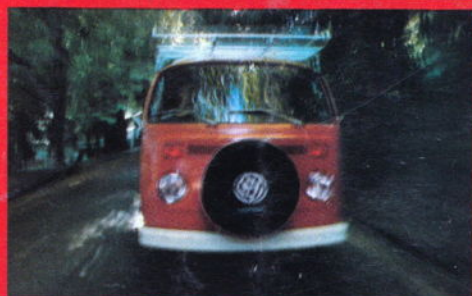
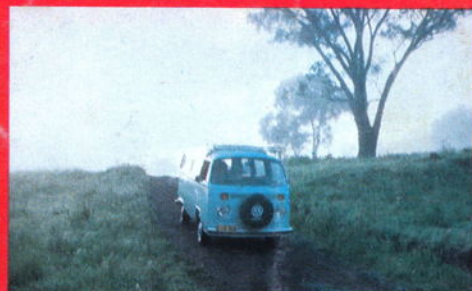

Volkswagen Australia Pty. Limited solely reserves the right, at its discretion and without notice, to change specifications and prices of the products referred to herein at any time and without incurring any liability whatsoever to any purchaser thereof. The colours of the cars shown in this catalogue are not necessarily standard colours. Volkswagen Australia Pty. Limited (a division of LNC Industries Limited)

