

**The VW Campmobile.
A Weekend and Vacation Volkswagen.**



A Volkswagen -



your home wherever you roam.



In the mountains, the VW Campmobile is your shelter, your refuge. In the midst of lonesome woods and lakes, your private resort hotel. On the road, your comfortable, roomy cruiser and your motel. Freedom's the word with the VW Campmobile — no timetables, no snags. Fancy free. Just get in and drive off, the world's your oyster. Without reservation worries, you can change plans overnight. Gloomy, rainy weather? Just pull up stakes. Sun shining? That's the ticket, you stay.

roads stop being roads with the VW Campmobile. Take a look underneath. Large wheels with radial ply tires, plenty of clearance and rear-wheel drive from the 1700 cc rear-mounted engine. That gives good traction, since wheels don't spin so easily when there's weight on them. What's more, many a posh sedan would envy the VW Campmobile's roadholding. That comes from its sports car chassis. Semi-trailing arm rear axle, stabilizer up front, finely balanced suspension, beautifully accurate steering with hydraulic steering



The VW Campmobile is both a comfortable and mobile vacation house. Slips through city traffic with ease and you can park it in any ordinary lot. Drives for hours at top speed on pikes and throughways. Takes to mountain roads like a duck to water. Fleet and maneuverable on narrow, twisty roads — leaves many a heavy trailer combine behind. And it's still your complete holiday house on wheels. The living room's great for kids. When you're rolling they can play, eat, or press their noses against the windows. The journey doesn't end where

damper, disk brakes front, drum brakes rear plus brake servo. And because this VW is an ardent nature lover, it conforms to the strictest exhaust emission control regulations of all — those from the U. S. When it comes to safety, the VW doesn't play around. A fun-mobile, yes. And even more, it's an excellent vehicle with all the comforts of home.

Living in your own home –



and what you can do
**without being
an old stay-at-home.**



Who doesn't want freedom and independence on vacation? Gives you lots of living and relaxation. Then why not take advantage of the freedom the VW Campmobile offers? Certainly Europe, as fascinating and beautiful as it is, should be seen from more than just the confines of a hotel room. The VW Campmobile lets you find all those quaint little nooks and crannies off the beaten track. When you hit the road in a VW Campmobile, you're fully equipped. No luggage to unpack. All your gear is stowed away neatly in cupboards and lockers. Easy to get at, just like home. Clothes are draped on hangers in the closet, which incidentally boasts a large mirror on the door. Socks and undies are tucked away in tidy compartments; linen goes into the locker under the bench seat. In other words, you've got everything you need right with you and a living room in fabulous good taste besides. The wood interior decor is in natural birch paneling; the furniture is supplied with easy-to-maintain synthetic fabric covering with teak trim. The foam-backed

leatherette seat covers are washable and match the cozy paneling. Drawable curtains on all windows plus a ceiling lamp to bring warm light into the room. A holiday house with that snug, lived-in feeling. And if you order the large, side-mounted tent for your VW Campmobile, this holiday house becomes even larger and roomier. The tent is free-standing and you can also pitch it away from your Campmobile.

You eat where you want –



and what you want.

With your VW Campmobile, you're not dependent on restaurants when you get hungry. And there's no need to risk strange food. Instead, you can include your favorite dishes as part of your travel experiences. Your Campmobile offers you everything needed to prepare meals. A drawer for cutlery, a seven gallon tank for fresh water. And to avoid shopping everyday, there's a food cabinet and a 1½-cubic-foot built-in ice box.

With the "Los Angeles" model, you get a stainless steel sink with a cover that becomes a practical drain board when folded back. The "Miami" and "Houston" versions offer a fold-out sideboard on the clothes closet. You draw water from the tank with a hand pump. Dish water drains out from the sink through an American-type drain. There's a wash unit with a folding table on the side of the food cabinet. Easy to use from

the outside through the open sliding door. Nothing like a little slack time after an event-packed vacation day and a tasty meal. Your VW Campmobile makes an excellent bedroom.



And sleep where you want –

When it comes to sacking out, the VW Campmobile offers you beds with genuine solid comfort. Always available, to stretch out for a mid-day snooze or bed down for the night.

Converting the living room into a bedroom is as easy as pie. Just pull the upholstered bench seat forward, fold down the backrest to meet the mattress above the engine compartment and, presto, you've got a full-size double bed. Linen is within easy reach in the locker under the bench seat.

Need more bunks for the kids? You can hang a child's bed up front over the seat in the cab. And if you order your Campmobile with a hinged pop-up roof, you've got another single or a double bed for children.

At the same time, you have more headroom in the living room, three windows with mosquito netting and a roof luggage pan. Your bedroom has windows all around with drawable curtains. And the VW Campmobile also offers louvered windows with mosquito netting to let the cool night air drift in after a hot day. Want a second bedroom separate from the first? No problem. The free-standing tent comes in handy again. Forms a large living unit with the VW Campmobile. Put it up anywhere you like, it's a dream come true.



but always in your own bed.

No matter what version you choose, you're certain to be delighted with it, since each is practical in its own way. The furnishings are attractively designed, stable and built into the vehicle. The upholstery is washable. All versions of the VW Campmobile come with varnished (natural) birch paneling. Roof and wall panels are insulated against heat and cold with Silan plating. The floor is springy and easy to clean since it's made of plywood and is covered with PVC with felt-lining underneath.

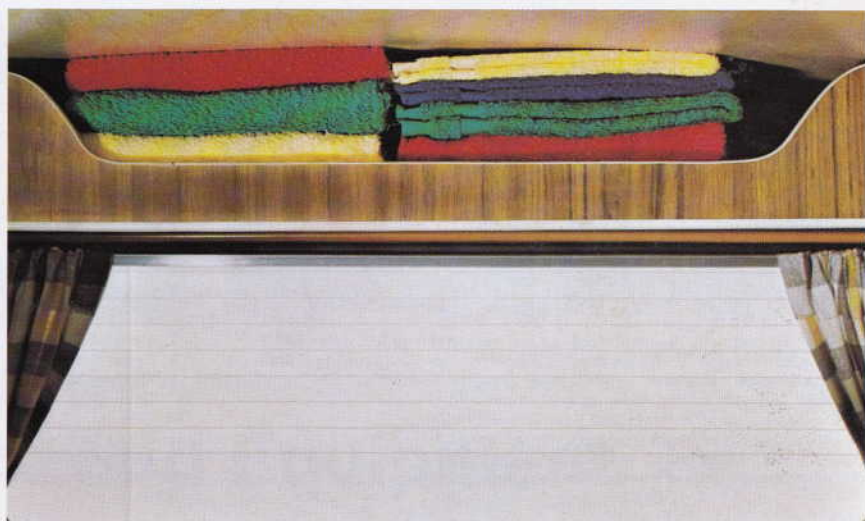

Three versions of the VW Camptmobile are available - tailor-made for different needs.

VW Camping Equipment "Los Angeles" Living Compartment

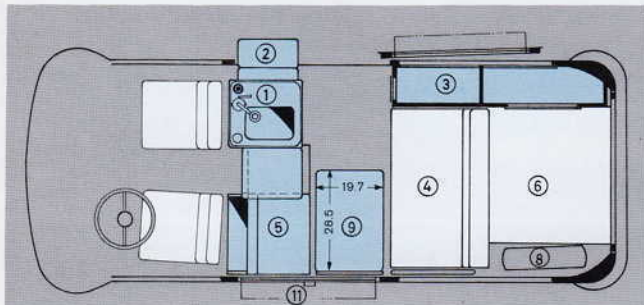

1. Food cabinet with 1½-cubic-foot ice box and seven gallon water tank. Stainless steel sink with hand pump and work top. American-type drain pipe for dish water plus air vent. Storage space under sink.
2. Wash unit with folding table on side of cabinet.
3. Clothes closet with mirror and linen cabinet behind.
4. Upholstered rear bench seat with storage space.
5. Upholstered front bench seat with storage space.
6. Upholstered mattress over engine compartment.

Bed Compartment

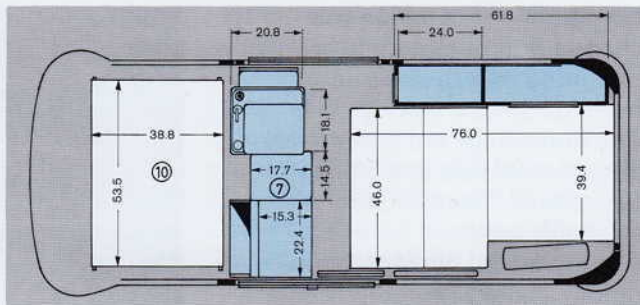

7. Upholstered stool between cabinet and front bench seat.
8. Spare tire cover.
9. Folding table. Cupboard under roof above engine compartment. Grab strap on clothes closet.
10. One child's bed in cab.
11. Mains socket for 110 V / 125 V (U. S. version).
12. Mosquito net for rear door. Safety belts in passenger compartment.
13. Two louvered windows with mosquito netting.

VW Camping Equipment "Houston" Living Compartment

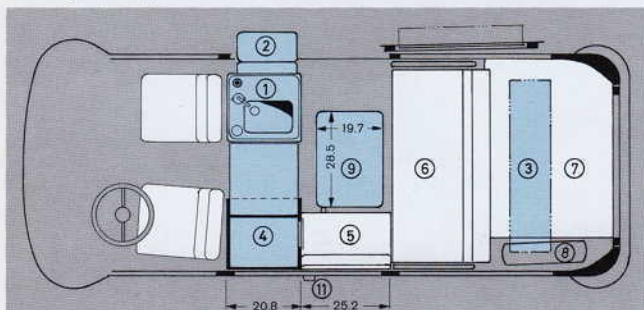

1. Food cabinet with 1½-cubic-foot ice box and seven gallon water tank. Stainless steel sink with hand pump and American-type drain pipe for dish water plus air vent. Storage space under sink.
2. Wash unit folding table on side of cabinet.
3. Linen cabinet suspended over engine compartment.
4. Clothes closet with mirror and fold-out dresser.
5. Upholstered bench seat with storage space.
6. Upholstered rear bench seat with storage space.

Bed Compartment

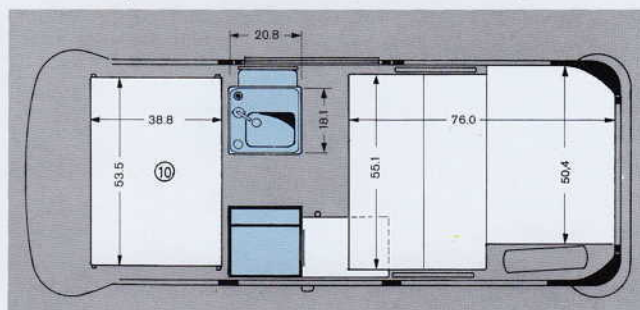

7. Upholstered mattress over engine compartment.
8. Spare tire cover.
9. Swiveling table. Wedge shaped cushion or backrest for side bench seat. Grab strap on door pillar.
10. One child's bed in cab.
11. Mains socket for 110 V / 125 V (U. S. version).
12. Mosquito net for rear door. Safety belts in passenger compartment.
13. One louvered window with mosquito netting.

VW Camping Equipment "Miami" Living Compartment

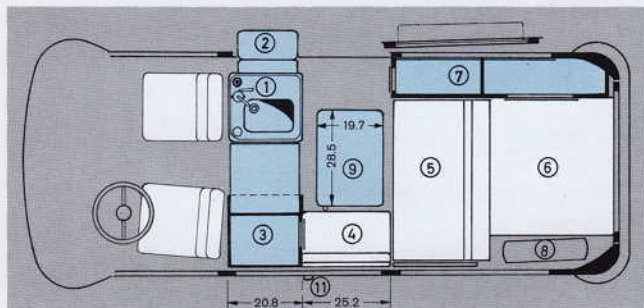

1. Food cabinet with 1½-cubic-foot ice box and seven gallon water tank. Stainless steel sink with hand pump and American type drain pipe for dish water plus air vent. Storage space under sink.
2. Wash unit folding table on side of cabinet.
3. Clothes closet with mirror and fold-out dresser.
4. Upholstered bench seat with storage space.
5. Upholstered rear bench seat with storage space.
6. Upholstered mattress over engine compartment.

Bed Compartment

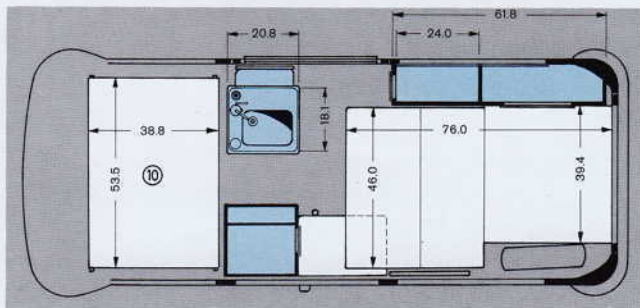

7. Multi-purpose cupboard for cutlery, linen etc.
8. Spare tire cover. Cupboard under roof above compartment.
9. Swiveling table. Wedge shaped cushion or backrest for side bench seat. Grab strap on multi-purpose cupboard.
10. One child's bed in cab.
11. Mains socket for 110 V / 125 V (U. S. version).
12. Mosquito net for rear door. Safety belts in passenger compartment.
13. One louvered window with mosquito netting.

You can also order extras for that extra special touch.

Hinged pop-up roof with one bed (67" x 23"), three windows with mosquito netting and roof luggage pan.

Hinged pop-up roof with bed for 2 children (67" x 23"), three windows with mosquito netting and roof luggage pan.

Cover for luggage pan.

Luggage roof rack. (Separate from hinged pop-up roof.)

Cover for luggage rack.

Mains socket for 220 V.

Heater pipe extension for Eberspaecher heater.

Refrigerator 12 V / 110 V, one cubic foot for food cabinet including second battery and separator relay.

Wedge shaped pillow.

Curtain (between cab and living room).

Large independently supported tent with floor and external frame.

Top flysheet for side tent.

2¹/₂ gallon water can.

Independent step with mat. Chemical toilet.

One can of Elsan fluid.

Cable drum with 80 feet of cable and connector cable for the German version with 220 V German Standard fittings only. See your VW dealer about your wishes.

He'll be glad to help you make your choice with some good tips.

Technical data and Equipment.

Engine: Four-cylinder, four-stroke, horizontally opposed, rear-mounted engine. Capacity 1679 cc. Bore x stroke 3.54 in. x 2.60 in. (90 x 66 mm). Compression ratio 7.3 : 1. Output 66 bhp (DIN) at 4800 rpm or 63 bhp (SAE net) at 4800 rpm. Maximum torque 83.9 ft. lbs. at 3200 rpm. (DIN) or 81 ft. lbs. at 3200 rpm (SAE net). Twin carburetor system with automatic choke. Thermostatically controlled fan air cooling. Special engine oil cooler. Exhaust emission control system in accordance with U. S. standards. The following deviations when used in conjunction with automatic transmission: Output 62 bhp (DIN) at 4200 rpm or 59 (SAE net) at 4200 rpm. Maximum torque 87 ft lbs at 3200 rpm.

Electrical system: Battery 12 V / 45 Ah. Alternator 55 amps. max. (approx. 770 Watts) with voltage regulator. Sealed beam headlights. Self-canceling turn indicators with hazard warning light system. Lane changer. Starter/ignition lock with non-repeat mechanism and buzzer for ignition key security. Door-contact operated inside light. Rheostat controlled instrument panel lighting. Two-speed, self-parking windshield wipers. Pneumatic windshield washer. Brake circuit failure telltale. Fuel gauge. Side reflectors. Electrically heated rear window. Two back-up lights.

Transmission: Via single plate dry clutch, fully and baulk synchronized, four-speed gearbox. Differential and double joint drive shafts to the rear wheels. Gear ratios, 1st to 4th gear: 3.78; 2.06; 1.26; 0.82; reverse 4.00. On request, at extra charge: Automatic

transmission with hydrodynamic torque converter and 3-speed epicyclic gears.

Chassis: Front and rear torsion bar suspension combined with double-acting telescopic shock absorbers. Wheel suspension and location by means of cranked trailing links up front and diagonal trailing arm at the back. Torsion bar stabilizer on the front axle. Hydraulic steering damper and safety steering column. Dual-circuit brake system with disk brakes front, drum brakes rear and brake servo. Tires: radial ply 185 SR 14 reinforced (tubeless).

Dimensions: Wheelbase 94.5 in. Track, front 54.9 in., rear 57.3 in. Overall dimensions, length 177.4 in., width 67.7 in. Overall height without additional roof structure, 76.4 in., with pop-up top, 80.1 in. Mean interior dimensions without camping equipment, length 110.2 in., width 60.6 in., height 55.1 in.

Weights: Unladen weight (without driver) 3296 lbs., payload (according to weight distribution) up to 1653 lbs. Permissible axle load, front 2227 lbs., rear 2800 lbs. Total permissible weight 4960 lbs.

Performance: (Deviations for automatic transmission in brackets) Maximum and cruising speed 78 mph (75 mph) Fuel consumption*) (regular gasoline) 18.2 miles per gallon (U. S.). Optimum hill climbing ability (maximum load on good roads, first gear 1 : 3.6 (forwards 1 : 4.5)).

Special Equipment: Cab: Plastic lined throughout including plastic foil in footwell. Floor lined with insulating rubber matting. Wheel housings damped with rubber. Driver's seat

adjustable to 9 positions, backrest over full range (even when vehicle is in motion). Passenger seat adjustable to 2 positions. Leatherette seat covers. Safety door locks. Coat hooks. Door pull-to mouldings. Safety rear view mirror. Ashtray. Grab handle for front seat passenger. Heating and ventilation systems adjustable over wide range. Ventilation air flow adjustable in all directions. Laminated windshield. Particularly effective windshield defrosting. Glove compartment with flap. Two padded sun visors. Safety belts for cab seats. Non-reflecting instrument panel padding in cab. Fuel gauge. Access to living compartment. (For special Campmobile equipment, see main text.)

Extras at extra charge: Windshield washer/wiper system with intermittent operation setting for wiper. Two electric blowers for fresh air ventilation system. Complete radio set with tape recorder socket, various versions available. Thermostatically controlled auxiliary and stationary heater. Vent wings in cab doors. Head restraints for all seats in drivers cab. Lock on engine compartment lid. Heavy duty shock absorbers. Mud flaps for rear wheels. Retractable step below sliding door. Body cavity preservation.

*) Consumption measured with half payload at steady ³/₄ of top speed plus 10 % (according to German Standards DIN 70030).

